

# 700 Dresher Road | Suite 200

Horsham, PA 19044

**workspace**  
property trust

## 39,480 SF Available Now

Office Space



# 700 Dresher Road I Suite 200

Horsham, Pennsylvania, 19044

## PROPERTY HIGHLIGHTS

### AMENITIES

700 Dresher Road is fully furnished, High-finish office designed by Gensler. Efficient single-floor plan with 3 sides of glass. Ample parking for a high-density user. 1 minute to 650 brand new apartments, Promenade at Upper Dublin, and numerous other retail and dining amenities.

### TRANSPORTATION

5 minutes to PA Turnpike.

Horsham Township's h.o.p.s shuttle service is also available to tenants, facilitating transportation between the SEPTA Regional Rail, the Horsham Business Center & the PA Lifestyle Campus.

### TECHNOLOGY

Comcast & Verizon throughout

### SUSTAINABILITY

Energy Star labeled building. Green initiatives in place by tenants and property management to include janitorial and recycling.

**Building Owner:** Workspace Property Trust

**Total Building Size:** 110,000

**Ceiling Height:** 8'6"



39,480 SF Available Now

Office Space





Open Work Area



Kitchen/Lounge Area



Conference Room

39,480 SF Available Now

700 Dresher Road | Suite 200

# 700 Dresher Road | Suite 200

Horsham, Pennsylvania 19044

**workspace**  
property trust

## 39,480 SF Available for Lease

Office Space



- High-finish office designed by Gensler
- Efficient single-floor plan with 3 sides of glass
- Ample parking for a high-density user
- 1 minute to 650 brand new apartments, Promenade at Upper Dublin, and numerous other retail and dining amenities
- <5 minutes to PA Turnpike
- Monument signage on Dresher Road

## Leasing Information

700 Dresher Road, Suite 150  
(215) 328-2732  
[www.workspaceproperty.com](http://www.workspaceproperty.com)

Doug Himmelreich  
Director of Leasing  
[D.Himmelreich@workspaceproperty.com](mailto:D.Himmelreich@workspaceproperty.com)





# Spaces for the Way Work Happens Today.

These beautifully designed themes inspire creativity and encourage productivity. Whether you are looking for 1,000 square feet or 100,000 square feet, our in-house design & development team can deliver a turnkey office solution.

## Tailored for the Evolution of Office:

- "A La Carte" or "On Demand" Furniture Packages Available
- Plug & Play IT Packages Available



Scan here to learn more about our premium theme selects.

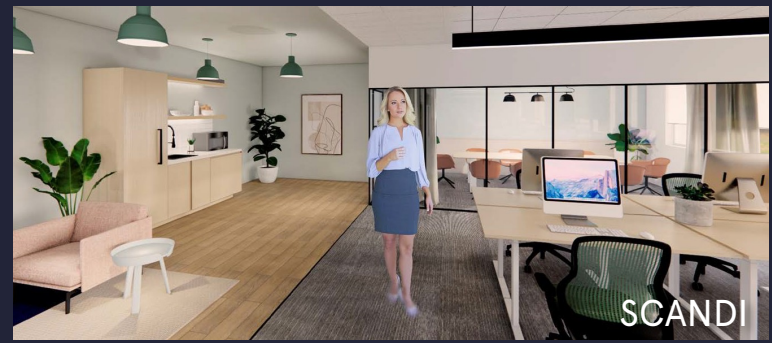

SCANDI



AZURE



TAHOE

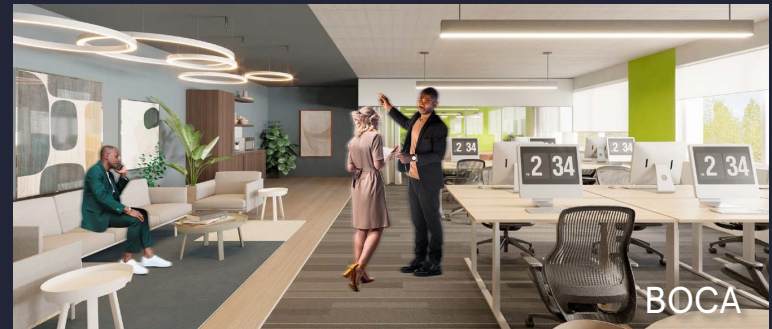

BOCA

\*Indicative of the look and feel (not the actual suite)