

200 Gibraltar Road | Suite 300

Horsham, PA 19044



10,286 SF Available 1/1/2025

Office Space



200 Gibraltar Road | Suite 300

Horsham, Pennsylvania, 19044

PROPERTY HIGHLIGHTS

AMENITIES

200 Gibraltar Road is in the Pennsylvania Business Campus and has convenient access to public transportation. This 3-story, Class "A" office building located in Horsham, PA offers plenty of amenities including: On-site Café serving breakfast & lunch, Electric car charging station (EV) as well as childcare located 1 minute from the office.

The PBC is surrounded by shopping centers, restaurants, fitness centers, banks, daycare and other amenities.

TRANSPORTATION

The Pennsylvania Business Campus is near the Pennsylvania Turnpike, Route 611 and Route 309 providing access to New York, Princeton, Trenton and Philadelphia.

Horsham Township's h.o.p.s shuttle service is also available to tenants, facilitating transportation between the SEPTA Regional Rail, the Horsham Business Center & the PA Lifestyle Campus.

Building Owner: Workspace Property Trust

Total Building Size: 64,452

Ceiling Height: 8'6"



10,286 SF Available 1/1/2025 Office Space



10,286 SF Available Available 1/1/2025

200 Gibraltar Road | Suite 300



Spaces for the Way Work Happens Today.

These beautifully designed themes inspire creativity and encourage productivity. Whether you are looking for 1,000 square feet or 100,000 square feet, our in-house design & development team can deliver a turnkey office solution.

Tailored for the Evolution of Office:

- “A La Carte” or “On Demand” Furniture Packages Available
- Plug & Play IT Packages Available



Scan here to learn more about our premium theme selects.

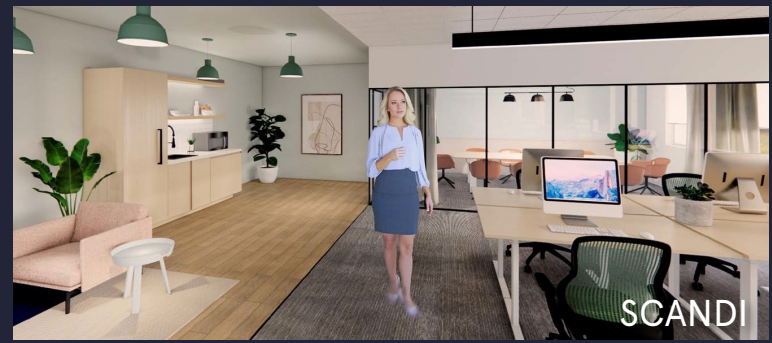

SCANDI



AZURE



TAHOE

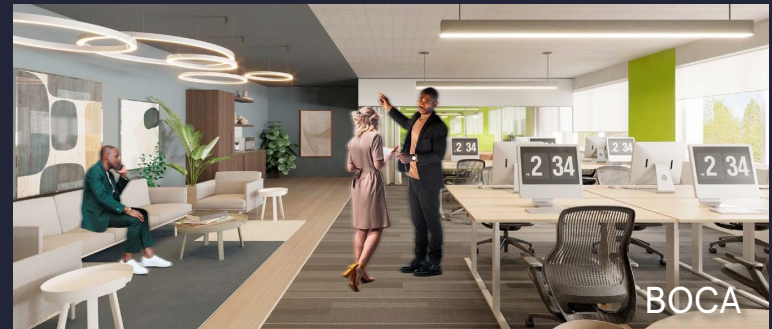

BOCA

*Indicative of the look and feel (not the actual suite)