

100 Witmer Road | Suite 200
Horsham, PA 19044

workspace
property trust

31,432 SF Available Now

Office Space



100 Witmer Road I Suite 200

Horsham, Pennsylvania, 19044

PROPERTY HIGHLIGHTS

AMENITIES

100 Witmer Rd, where modern updates and prime location converge. The updated atrium lobby features new collaborative furniture and guest Wi-Fi, creating a welcoming and functional environment. Located at the highly visible intersection of Blair Mill and Witmer Roads within the PA Lifestyle Campus, this office building offers convenient access to public transportation. With its proximate location to the Pennsylvania's Turnpike, routes 611, 63 and 309 providing access to New York, Princeton, Trenton and Philadelphia, 100 Witmer is a must-visit for business professionals welcoming clients across the tri-state.

Tenants enjoy the proximity to countless lifestyle centers, the walkability to restaurants, and numerous on-site amenities throughout our campus such as:

- On-site Beer Garden at 100 Lakeside
- On-site Fitness AND Cafe at 100 Witmer Rd
- On-site EV charging stations throughout campus
- On-site Fitness Center at 100 Lakeside
- Synergy at 100 Lakeside Conference Center
- Fully equipped conference facility at 200 Gibraltar
- Access to (5) daycares minutes from the office
- 555 Flats Luxury Living under 1 mile away
- Shopping at the Upper Dublin Promenade under 2 miles away

Building Owner: Workspace Property Trust

Total Building Size: 139,128

Ceiling Height: 8'6"



31,432 SF Available Now

Office Space

100 Witmer Road | Suite 200

Horsham, Pennsylvania 19044

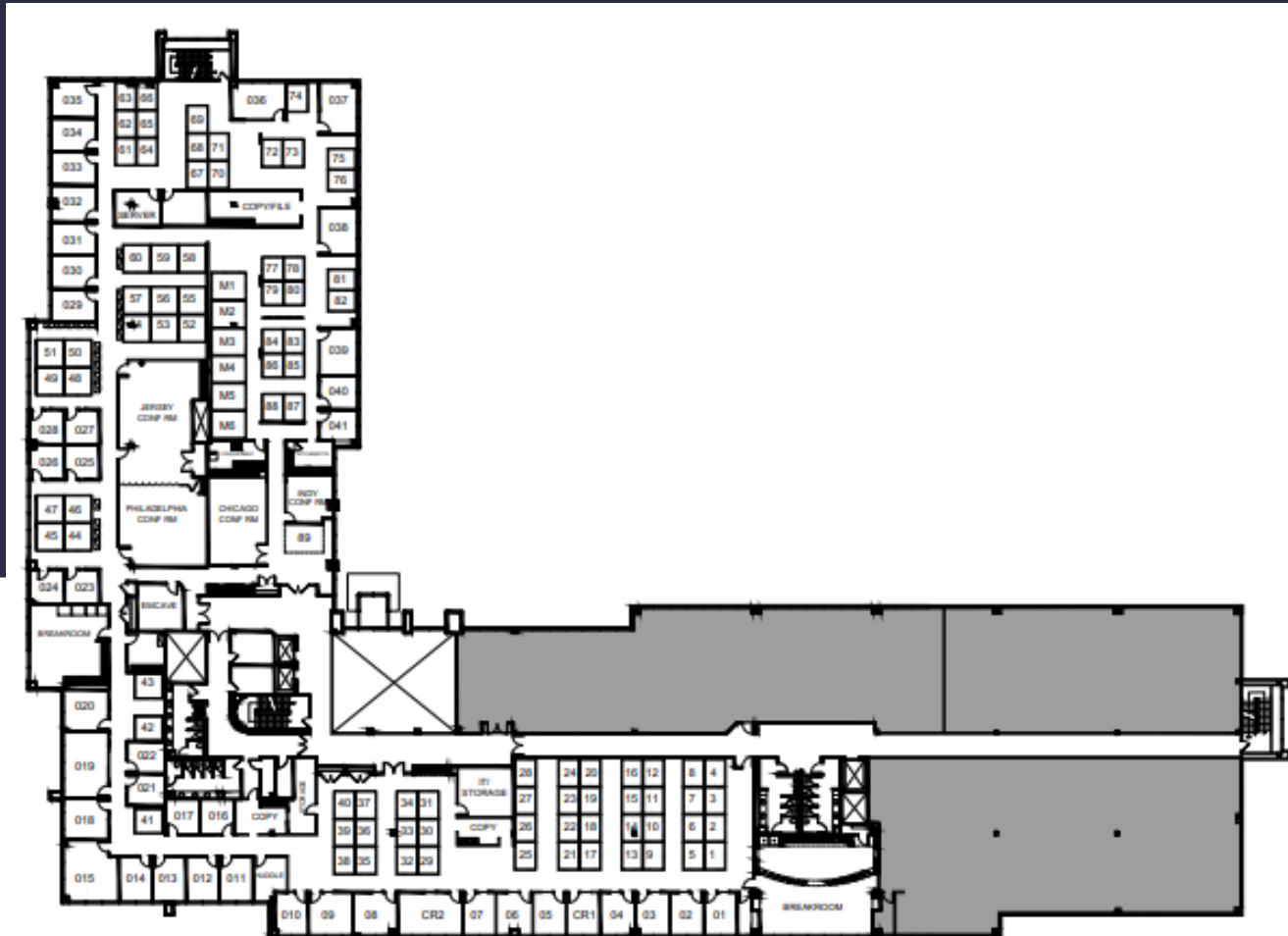

Leasing Information

700 Dresher Road, Suite 150
(215) 328-2732
www.workspaceproperty.com

Doug, Himmelreich
Director of Leasing
dhimmelreich@workspaceproperty.com



Spaces for the Way Work Happens Today.

These beautifully designed themes inspire creativity and encourage productivity. Whether you are looking for 1,000 square feet or 100,000 square feet, our in-house design & development team can deliver a turnkey office solution.

Tailored for the Evolution of Office:

- "A La Carte" or "On Demand" Furniture Packages Available
- Plug & Play IT Packages Available



Scan here to learn more about our premium theme selects.

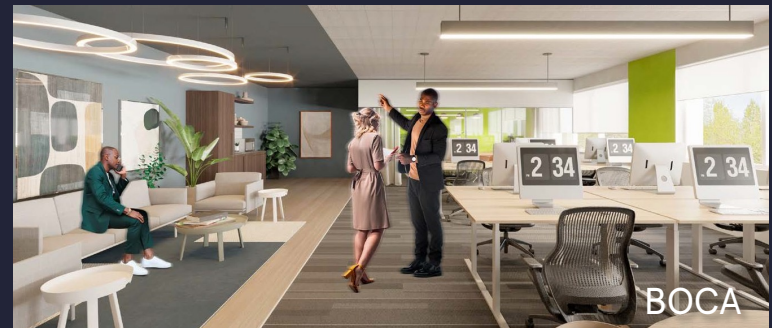
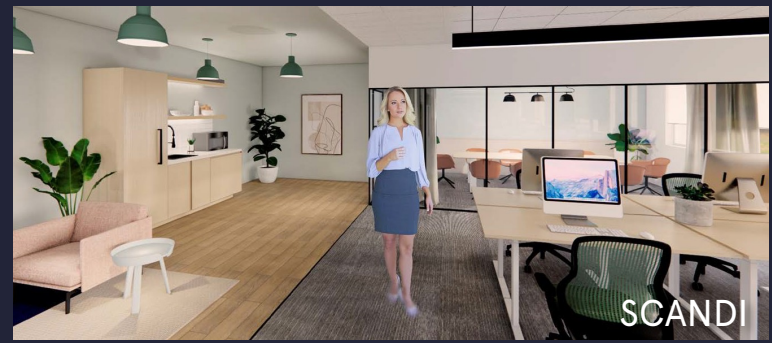

*Indicative of the look and feel (not the actual suite)