

# 100 Witmer Road | Suite 300

Horsham, PA 19044

**workspace**  
property trust

## 6,169 SF Available Now

Office Space





# 100 Witmer Road I Suite 300

Horsham, Pennsylvania, 19044

## PROPERTY HIGHLIGHTS

### AMENITIES

100 Witmer Rd, where modern updates and prime location converge. The updated atrium lobby features new collaborative furniture and guest Wi-Fi, creating a welcoming and functional environment. Located at the highly visible intersection of Blair Mill and Witmer Roads within the PA Lifestyle Campus, this office building offers convenient access to public transportation. With its proximate location to the Pennsylvania's Turnpike, routes 611, 63 and 309 providing access to New York, Princeton, Trenton and Philadelphia, 100 Witmer is a must-visit for business professionals welcoming clients across the tri-state.

Tenants enjoy the proximity to countless lifestyle centers, the walkability to restaurants, and numerous on-site amenities throughout our campus such as:

- On-site Beer Garden at 100 Lakeside
- On-site Fitness AND Cafe at 100 Witmer Rd
- On-site EV charging stations throughout campus
- On-site Fitness Center at 100 Lakeside
- Synergy at 100 Lakeside Conference Center
- Fully equipped conference facility at 200 Gibraltar
- Access to (5) daycares minutes from the office
- 555 Flats Luxury Living under 1 mile away
- Shopping at the Upper Dublin Promenade under 2 miles away

**Building Owner:** Workspace Property Trust

**Total Building Size:** 139,128

**Ceiling Height:** 8'6"



**6,169 SF Available Now**

Office Space

# 100 Witmer Road | Suite 300

Horsham, Pennsylvania 19044



6,169 SF Available Now

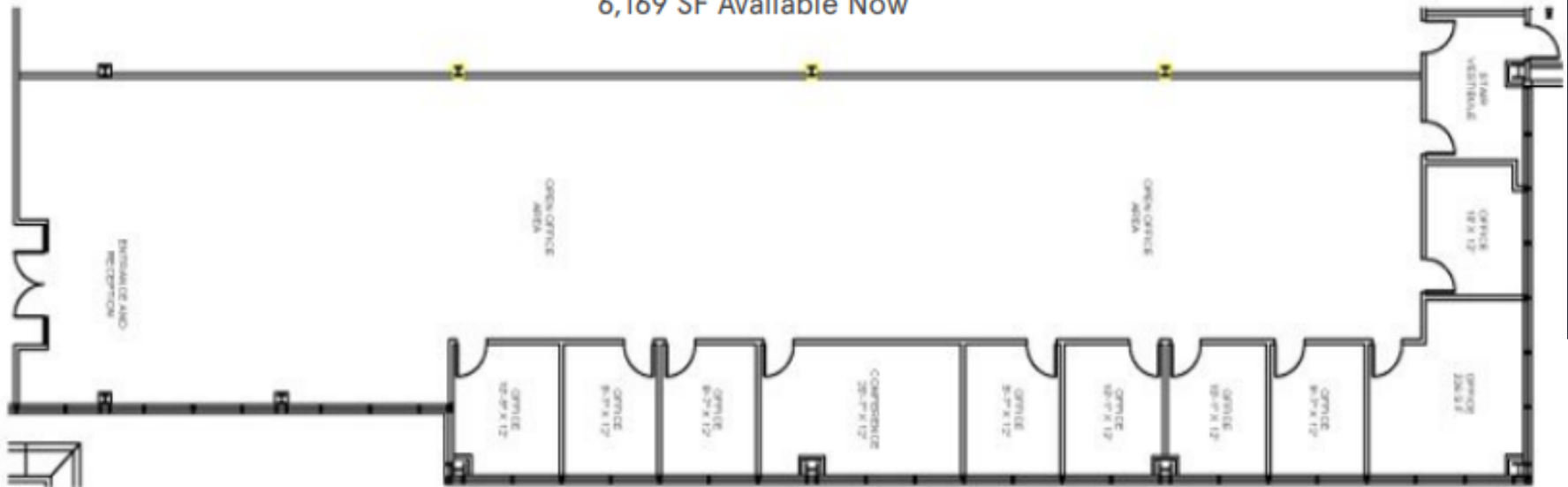

## Leasing Information

700 Dresher Road, Suite 150  
(215) 328-2732  
[www.workspaceproperty.com](http://www.workspaceproperty.com)

Doug, Himmelreich  
*Director of Leasing*  
[dhimmelreich@workspaceproperty.com](mailto:dhimmelreich@workspaceproperty.com)



# Spaces for the Way Work Happens Today.

These beautifully designed themes inspire creativity and encourage productivity. Whether you are looking for 1,000 square feet or 100,000 square feet, our in-house design & development team can deliver a turnkey office solution.

## Tailored for the Evolution of Office:

- "A La Carte" or "On Demand" Furniture Packages Available
- Plug & Play IT Packages Available



Scan here to learn more about our premium theme selects.

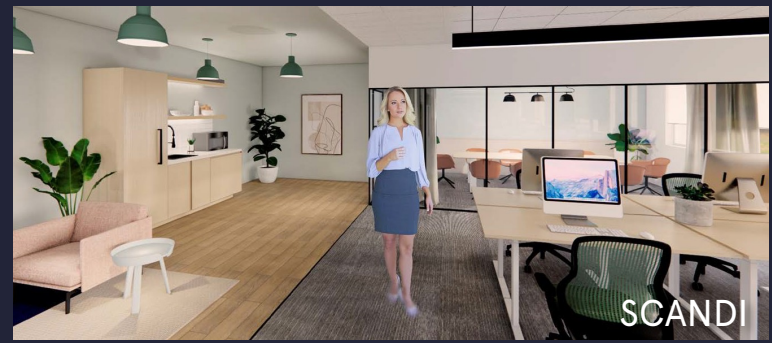

SCANDI



AZURE



TAHOE

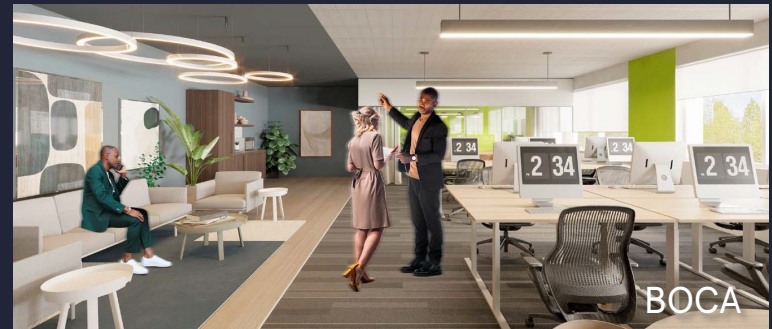

BOCA

\*Indicative of the look and feel (not the actual suite)